



# HUNTER - AMARYLLIS - CEILING FAN WIRING AND LIGHTING GUIDE

## Wiring the Fan

**We know wiring is hard. Let's make it easier.**

Follow these steps to get your fan wired quickly and safely. Follow the route below that best matches your wall switch setup. If you are unfamiliar with wiring or uncomfortable doing it yourself, please contact a qualified electrician.

### Hunter Pro Tip:

#### Here is how to connect the wires:

Push the bare metal ends of the wires together and slide a wire nut over them. Then, twist the wire nut clockwise until tight. Give it a gentle pull to make sure none of the wires are loose.

### WARNING

The ceiling fan must be grounded. If the ground wire for the installation site is not present, immediately **STOP** installation and consult a qualified electrician.

### WARNING

All wiring must be in accordance with national and local electrical codes ANSI/NFPA 70. If you are unfamiliar with wiring or in doubt, consult a qualified electrician.

### Hunter Pro Tip:

#### Have extra wiring?

Turn the wires upward and push them carefully back through the hanger bracket into the outlet box. Spread the wires apart, with the grounded wires on one side of the outlet box and the ungrounded wires on the other side of the outlet box. Make sure that the wires are still attached to the wire nuts.

Connect the black (ungrounded) wire from the ceiling to the black wire from the receiver.

Connect the yellow wire from the receiver to the black wire from the fan.

Connect the white (grounded) wire from the ceiling to both the white wire from the receiver and the white wire from the fan.



### Note:

Fan style may vary.

Connect the blue wire from the receiver to the blue wire from the fan.

Connect the three grounding wires (green, green/yellow stripe, or bare copper) coming from the ceiling, downrod, and hanging bracket.

Ceiling Bracket Downrod Hanging Fan Wiring Canopy Blades Light Control

6



#2 Chootoo Road, South Aranguez, San Juan, Trinidad



# HUNTER - AMARYLLIS - CEILING FAN WIRING AND LIGHTING GUIDE

## Installing the Canopy

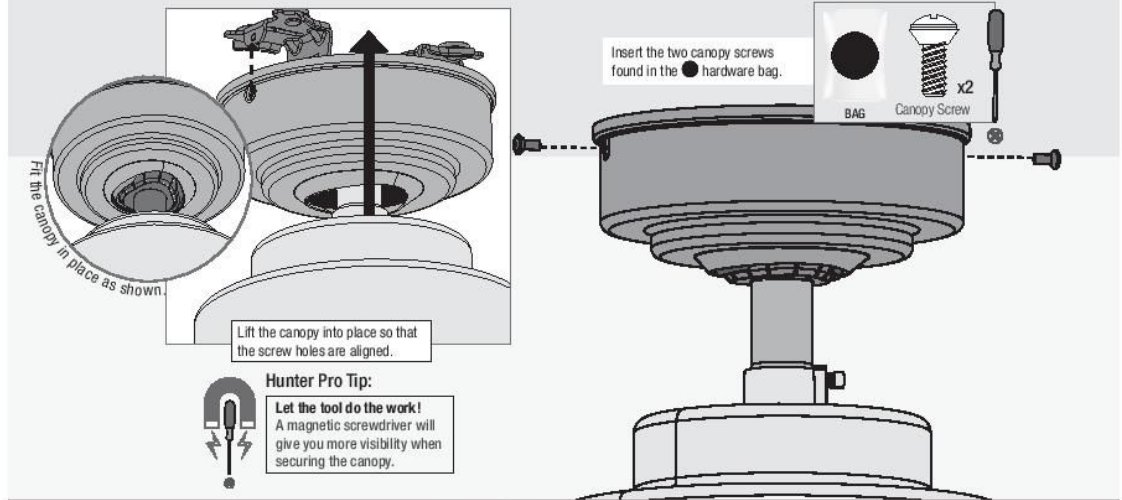

## Installing the Blades:

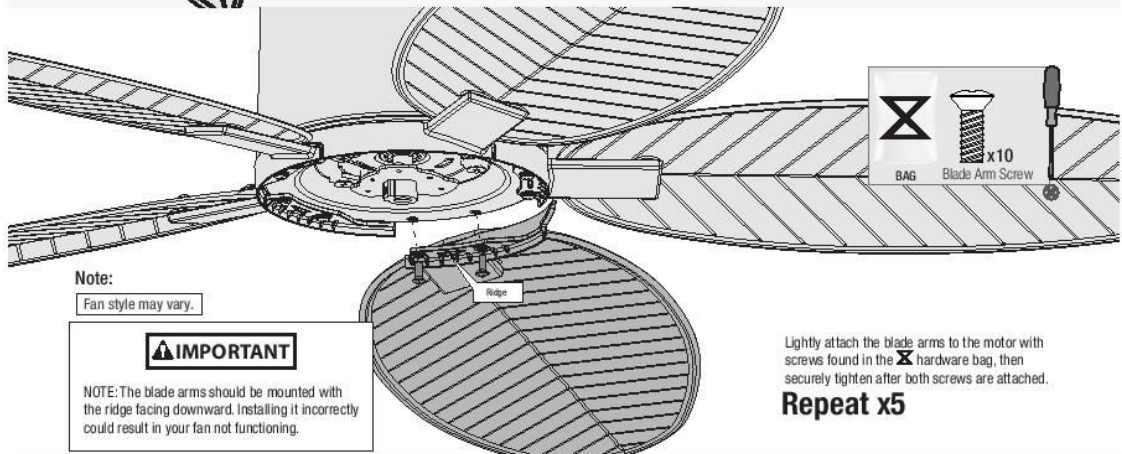
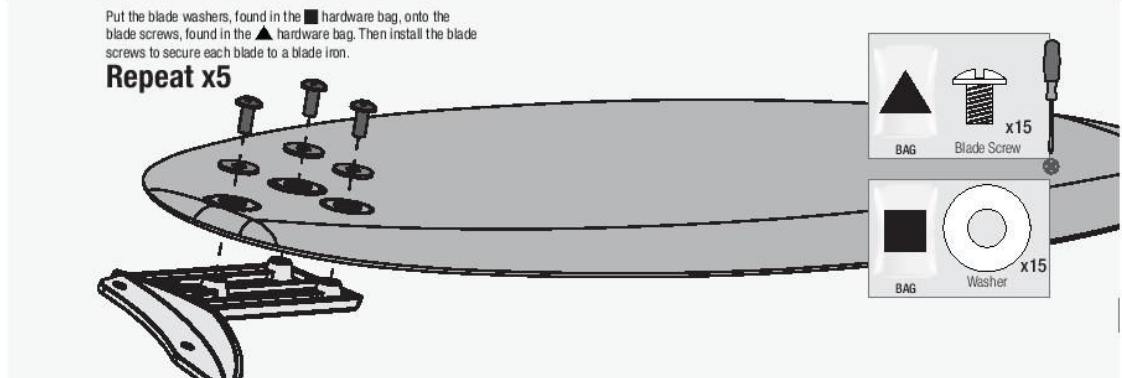



# HUNTER - AMARYLLIS - CEILING FAN WIRING AND LIGHTING GUIDE

## Assembling the Light Kit

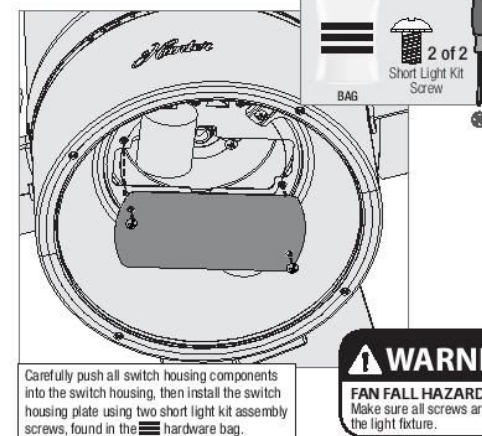
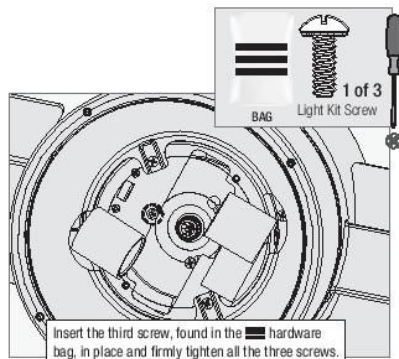
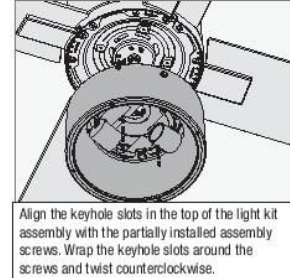
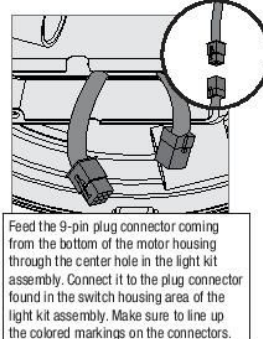
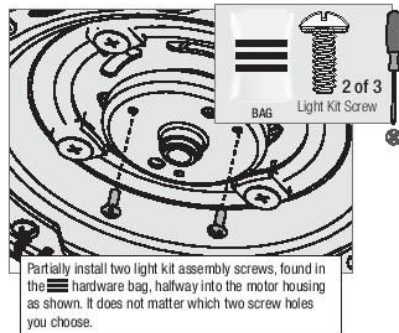

**Note:**  
Fan style may vary.

## Light Kit

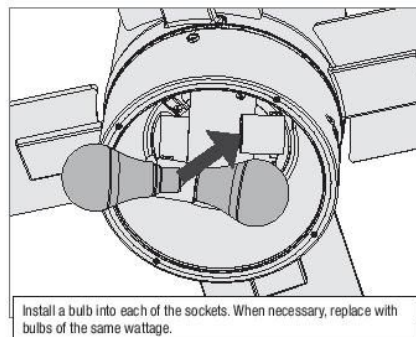

**Repeat x2**

**Note:**  
Fan style may vary.

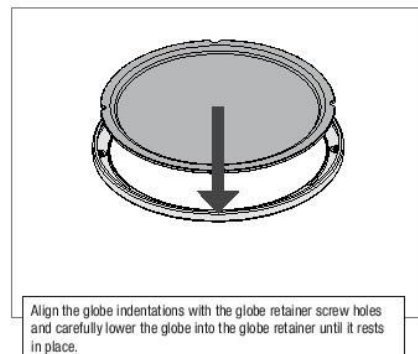

# HUNTER - AMARYLLIS - CEILING FAN WIRING AND LIGHTING GUIDE

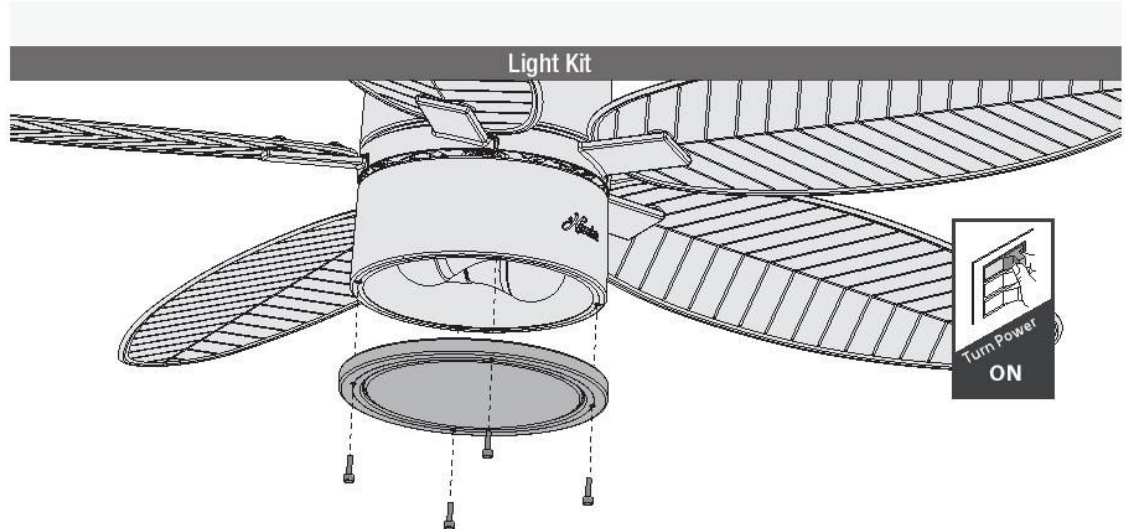

**WARNING**  
GLASS FALL HAZARD  
To prevent SERIOUS INJURY or DEATH, make sure that glass is properly secured.

Lift the globe assembly and attach it to the upper switch housing using the four thumbscrews. Tighten all four screws securely by hand.

